

Jika berhasil login, untuk mengerjakan tes silahkan ikuti langkah-langkah seperti dibawah ini:

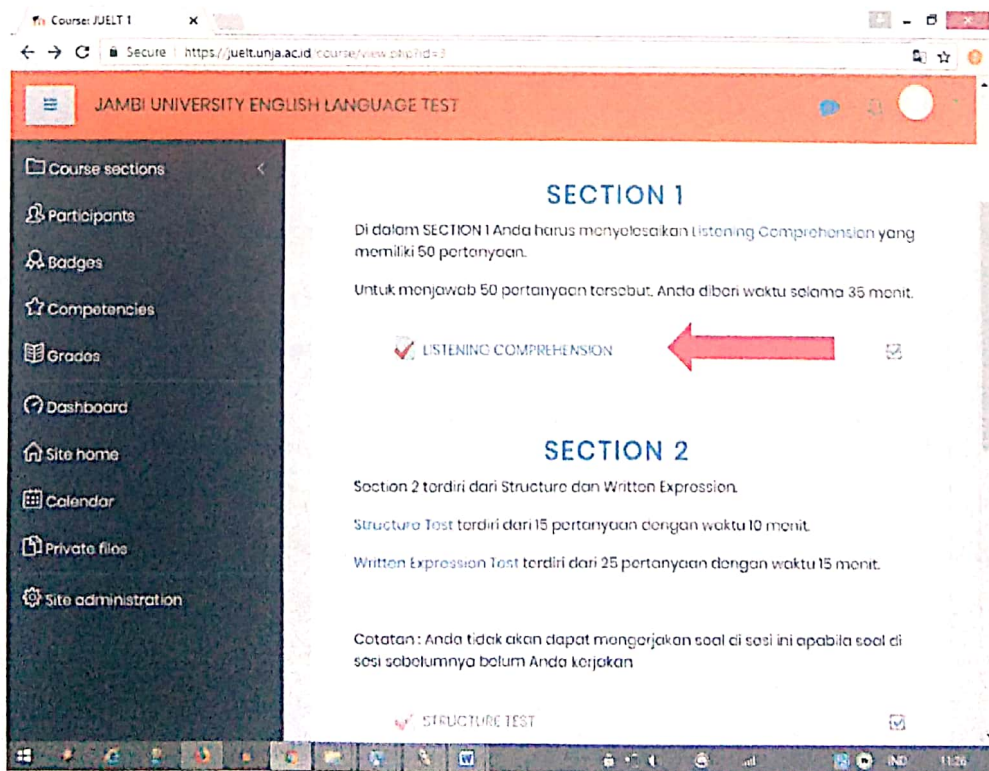

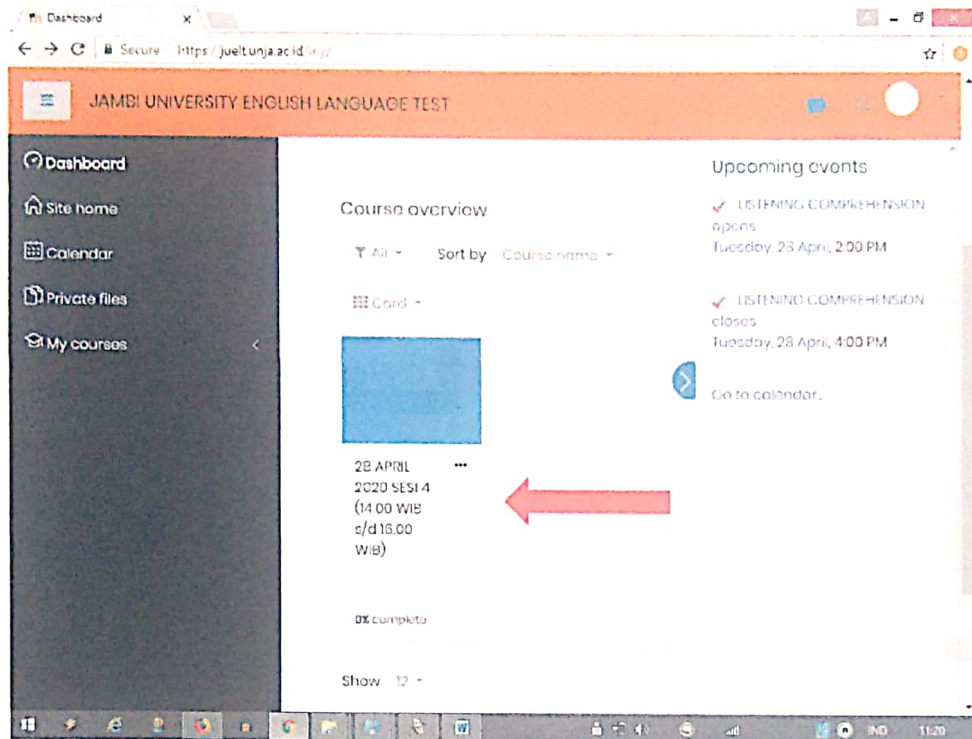
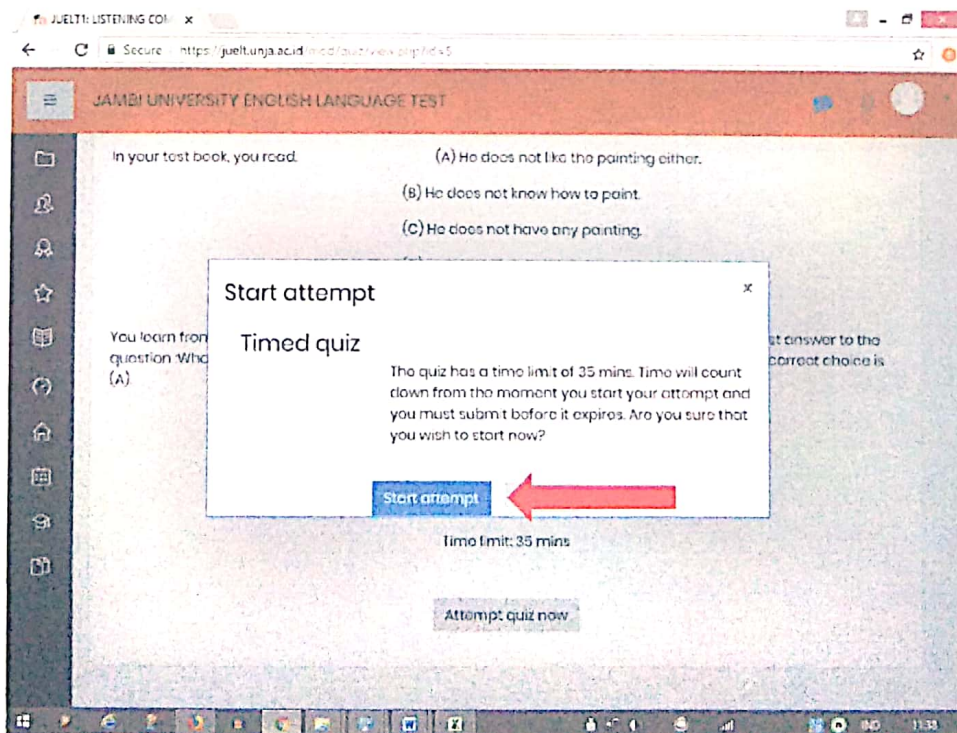
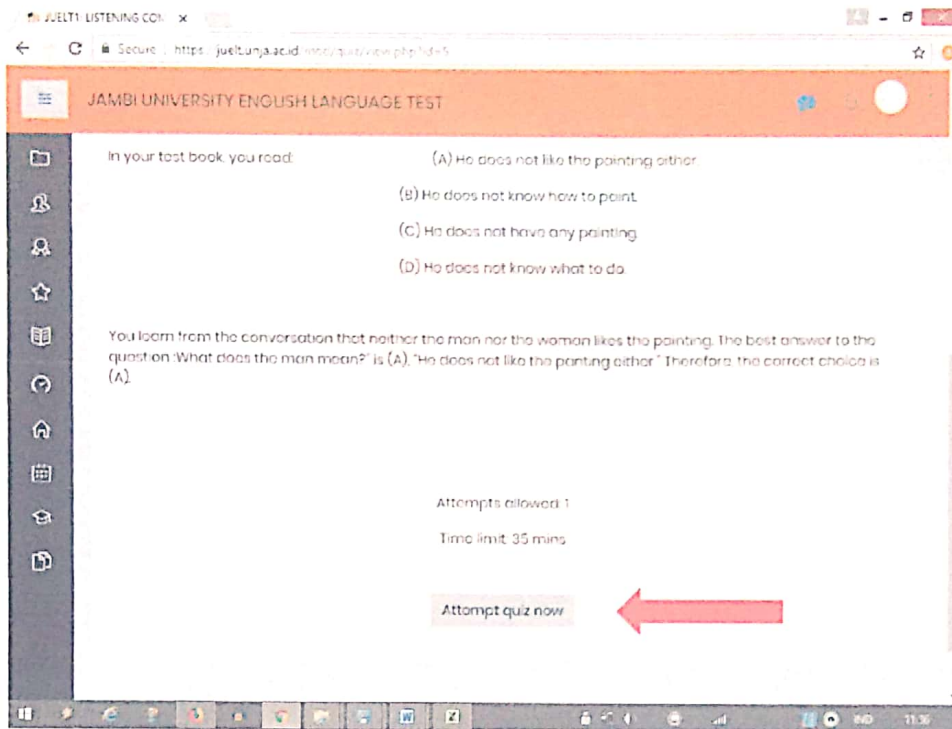

LISTENING COMPREHENSION

Secure | https://juet.unja.ac.id/mod/quiz/attempt.php?attempt=6667&cmid=5

JAMBI UNIVERSITY ENGLISH LANGUAGE TEST

Question 1
Not yet answered
Marked out of 1
Flag question

Select one:

- a. Attend summer-session classes with Jeff
- b. Ask Jeff if he needs a roommate
- c. Help Jeff move to a new place
- d. Ask Jeff to recommend some classes

Next page

Quiz navigation

1	2	3	4
5	6	7	8
9	10	11	12
13	14	15	16
17	18	19	20
21	22	23	24
25	26	27	28
29	30	31	32
33	34	35	36
37	38	39	40
41	42	43	44
45	46	47	48

LISTENING COMPREHENSION

Secure | https://juet.unja.ac.id/mod/quiz/attempt.php?attempt=6667&cmid=5

JAMBI UNIVERSITY ENGLISH LANGUAGE TEST

Next page

21	22	23	24
25	26	27	28
29	30	31	32
33	34	35	36
37	38	39	40
41	42	43	44
45	46	47	48
49	50		

Finish attempt ...

Time left 0:29:18

Stay in touch

Data retention summary

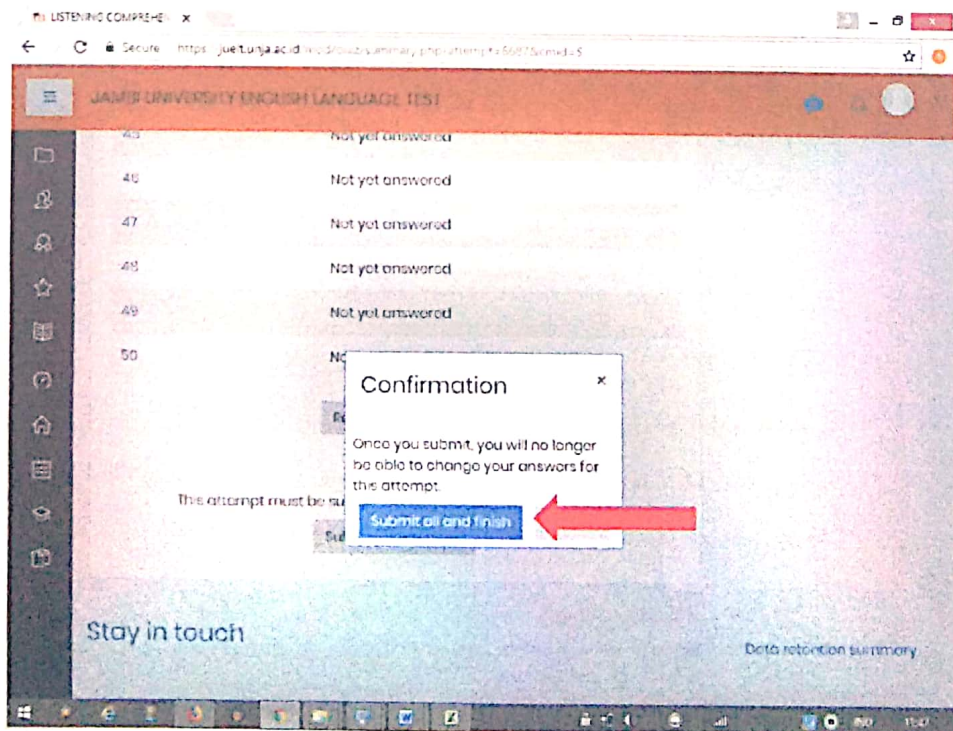
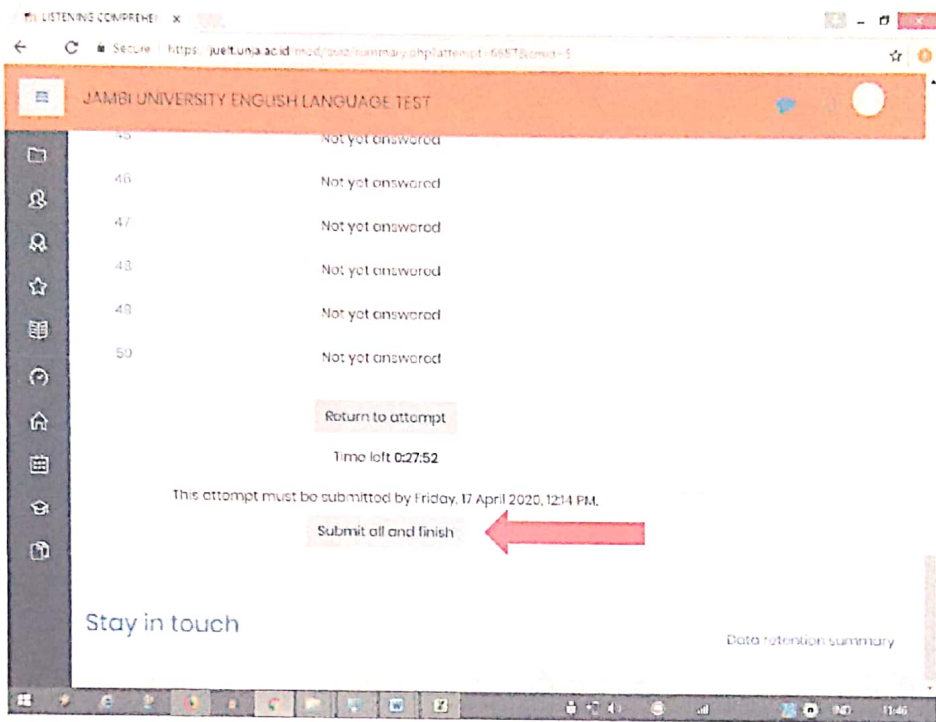

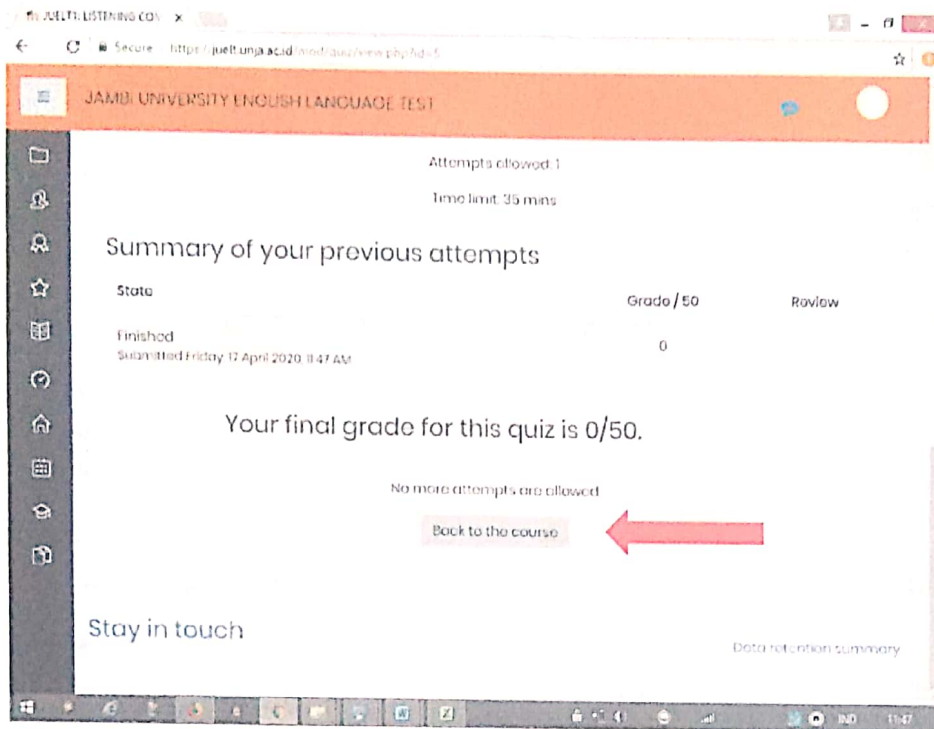

Kerjakan sesi berikutnya dengan step yang sama dengan sesi Listening Comprehension

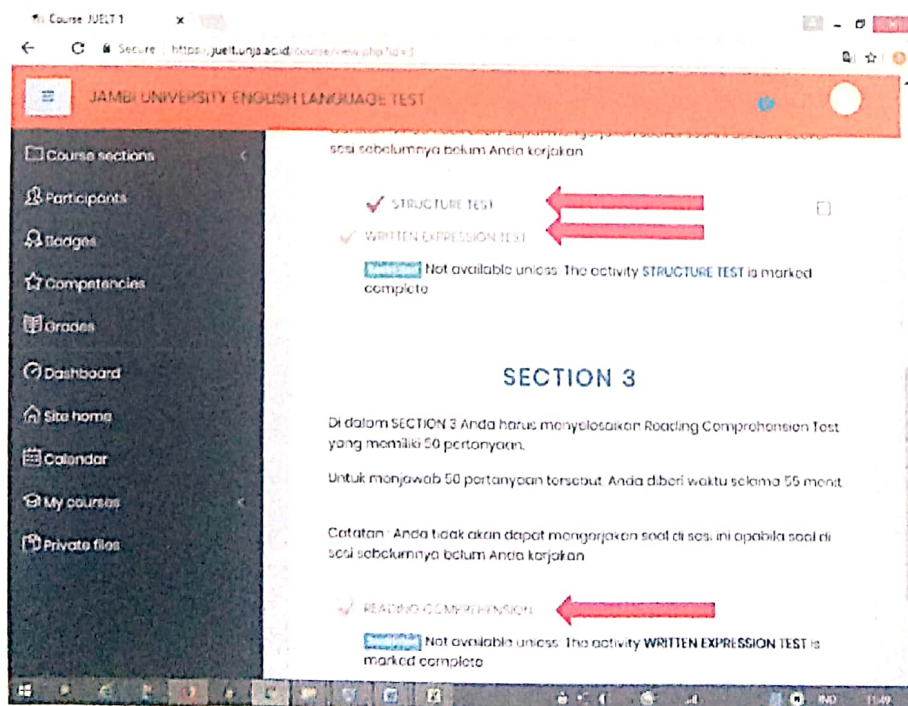

Jika sudah mengerjakan semua sesi, klik menu grade untuk melihat hasil tes.

The screenshot shows the 'Grades View' page for the 'JAMBI UNIVERSITY ENGLISH LANGUAGE TEST'. The sidebar menu on the left includes options like 'Course sections', 'Participants', 'Badges', 'Competencies', 'Grades', 'Dashboard', 'Site home', 'Calendar', 'My courses', and 'Private files'. The 'Grades' menu item is highlighted in blue, with a red arrow pointing to it. The main content area displays a table of grade items:

Grade Item	Grade
JUULT 1	
SECTION 1	
✓ LISTENING COMPREHENSION	0
SECTION 1 total include empty grades	20
SECTION 2	
✓ STRUCTURE TEST	-
✓ WRITTEN EXPRESSION TEST	-
SECTION 2 total include empty grades	-
SECTION 3	
READING COMPREHENSION	